

The TXG is the industry's most compact shell-and-tube evaporator.



TXG 1-Circuit Design Features and Ratings

Models	R-22 Nom'l Cap. Tons	R-134a Nom'l Cap. Tons	R-22 Press. Drop (psi)	R-134a Press. Drop (psi)	Shell Dia. (in)	Dimensions (inches)						Connections (inches)		
						A	B	C	D	E	F	P (ids)	S (fpt)	T (fpt)
1-Circuit														
TXG30-1	29.8	24.2	4.9	3.3	8 5/8	43 1/2	27 1/2	7 4/5	7 4/5	6	11 7/8	5/8	3/8	0.75
TXG40-1	40.3	32.6	5.8	3.8	10 3/4	43 1/2	27 1/2	8 7/8	8 7/8	7 1/8	14 1/4	7/8	3/8	0.75
TXG50-1	50.1	40.8	6.8	4.6	10 3/4	43 1/2	26 1/2	8 7/8	8 7/8	7 1/8	14 1/4	1 1/8	1/2	1
TXG60-1	59.9	48.5	5.6	3.7	12 3/4	43 1/2	26 1/2	9 7/8	9 7/8	8 4/9	16 7/8	1 3/8	1/2	1 1/4
TXG70-1	69.8	56.7	6.2	4.1	12 3/4	43 1/2	25 4/9	9 7/8	9 7/8	8 4/9	16 7/8	1 3/8	1/2	1 1/4
TXG85-1	84.2	68.3	4.0	2.7	14	44 1/2	25 4/9	11 1/2	11 1/2	9	17 7/8	1 5/8	1/2	2
TXG100-1	100.6	81.8	5.6	3.8	16	45	25 4/9	12 1/2	12 1/2	10	20 1/8	1 5/8	1/2	2
TXG115-1	116.1	93.2	5.7	3.7	16	45	24 3/8	12 1/2	12 1/2	10	20 1/8	2 1/8	1/2	2
TXG130-1	129.1	105.3	6.4	4.4	18	45 1/2	24 3/8	13 1/2	13 1/2	11 1/8	22 1/4	2 1/8	1/2	2 1/2
TXG150-1	151.2	118.8	6.7	4.2	18	51	30 3/8	13 1/2	13 1/2	11 1/8	22 1/4	2 1/8	1/2	3
TXG190-1	189.4	151.6	3.8	2.5	20	51	28 3/8	14 1/2	14 1/2	12 1/8	24 1/4	2 5/8	1/2	3

Shell Side Working Pressure: 225 psi @ 150°F
 Tube Side: 150 psi @ 150°F (Non-Code)

Flanged Connections available on request
 Insulation available on request

*Nominal ratings: Include an additive fouling coefficient of 0.0001 ft² hr²F/Btu over clean rating per AHRI standard 480-2007
 TR = 12,000 Btu/hr

- Single and dual-circuit designs
- Accurate ratings to AHRI 480-95
- 22 TXG models from 30 to 190 tons
- More resistant to localized freeze-ups
- Ideal for OEM replacements
- Design resists clogging and premature failure
- Serviceable

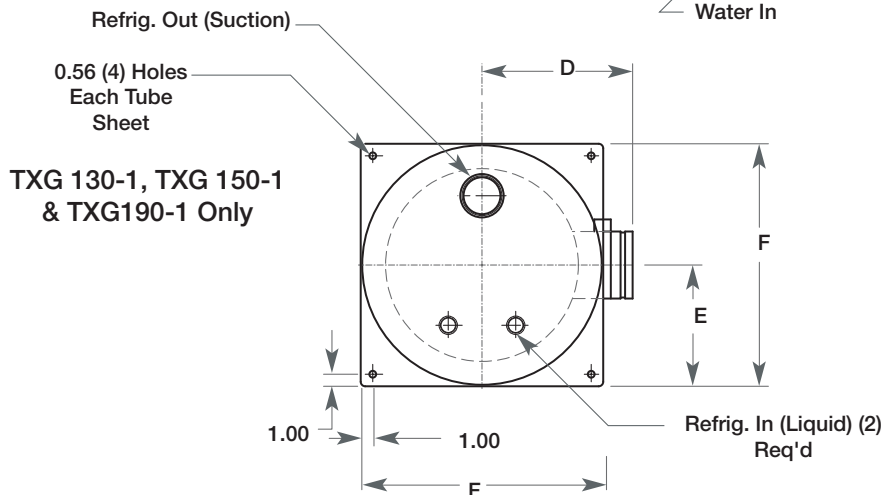
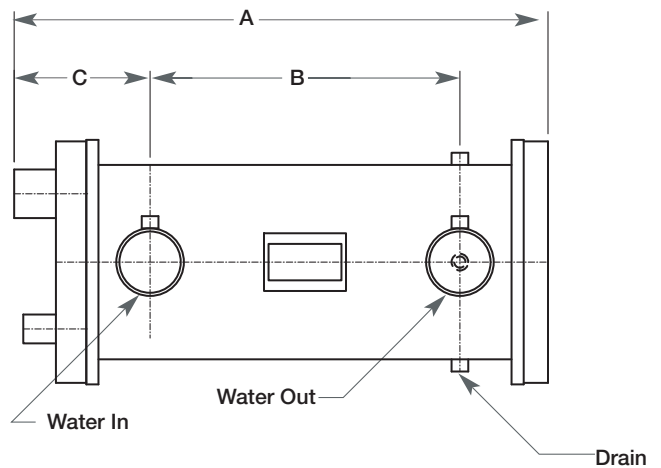

The TXG is the industry's most compact shell-and-tube evaporator.



TXG - 2-Circuit Design Features and Ratings

Models	R-22 Nom'l Cap. Tons	R-134a Nom'l Cap. Tons	R-22 Press. Drop (psi)	R-134a Press. Drop (psi)	Shell Dia. (in)	Dimensions (inches)						Connections (inches)		
						A	B	C	D	E	F	P (ids)	S (fpt)	T (fpt)
2-Circuit														
TXG30-2	29.8	24.2	4.9	3.3	8 5/8	42 2/3	27 1/2	9 4/9	7 4/5	6	11 7/8	3	7/8	1 5/8
TXG40-2	40.3	32.6	5.8	3.8	10 3/4	42 2/3	27 1/2	9 4/9	8 7/8	7 1/8	14 1/4	3	7/8	1 5/8
TXG50-2	50.1	40.8	6.8	4.6	10 3/4	43	26 1/2	10 1/5	8 7/8	7 1/8	14 1/4	4	1 1/8	2 1/8
TXG60-2	59.9	48.5	5.6	3.7	12 3/4	43 3/4	26 1/2	10 3/4	9 7/8	8 4/9	16 7/8	4	1 1/8	2 1/8
TXG70-2	69.8	56.7	6.2	4.1	12 3/4	43 2/3	26	11	9 7/8	8 4/9	16 7/8	5	1 1/8	2 5/8
TXG85-2	84.2	68.3	4.0	2.7	14	44	26	11	11 1/2	9	17 7/8	5	1 3/8	2 5/8
TXG100-2	100.6	81.8	5.6	3.8	16	44	25 1/2	11 1/5	12 1/2	10	20 1/8	5	1 3/8	2 5/8
TXG115-2	116.1	93.2	5.7	3.7	16	43 1/3	24 3/8	11 1/8	12 1/2	10	20 1/8	6	1 3/8	3 1/8
TXG130-2	129.1	105.3	6.4	4.4	18	45	24 3/8	12 1/4	13 1/2	11 1/8	22 1/4	6	1 5/8	3 1/8
TXG150-2	151.2	118.8	6.7	4.2	18	51	30 3/8	12 1/4	13 1/2	11 1/8	22 1/4	6	1 5/8	3 1/8
TXG190-2	189.4	151.6	3.8	2.5	20	51 2/3	28 3/8	13 1/2	14 1/2	12 1/8	24 1/4	8	1 5/8	3 5/8

Flanged Connections available on request

Insulation available on request

*Nominal ratings: Include an additive fouling coefficient of 0.0001 ft² hr°F/Btu over clean rating per AHRI standard 480-2007

TR = 12,000 Btu/hr

Shell Side Working Pressure: 225 psi @ 150°F

Tube Side: 150 psi @ 150°F (Non-Code)

- Single and dual-circuit designs
- Accurate ratings to AHRI 480-95
- 22 TXG models from 30 to 190 tons
- More resistant to localized freeze-ups
- Ideal for OEM replacements
- Design resists clogging and premature failure
- Serviceable

